

FAAC Entrance Solutions UK



Unit 9, Windmill Business Village, Brooklands Close, Sunbury on Thames, United Kingdom, TW16 7DY

<https://www.faacentrancesolutions.co.uk/>

Cpd Contact, Tel: +44 (0)333 006 3443, architect.esuk@faacgroup.com

CPD Overview

FAAC Entrance Solutions UK Ltd are the sole supplier of all ASSA ABLOY Automatic Pedestrian Doors in the UK, we install, maintain, repair and modernise automated entrance products for all types of facilities. Our experts offer systems and solutions tailored to end-users in all market sectors.

As part of the global FAAC brand, we also supply and install Magnetic Security Products, where we offer security solutions in assisting with access control security lanes, helping to screen and verify both employees and visitors. Magnetic have been collaborating with all market sectors and system integrators worldwide for many years, and we have comprehensive experience in the planning, installation and maintenance of access control systems.

FAAC has built an impressive reputation in the market by providing an innovative and wide product portfolio to deliver cost effective and exceptionally reliable solutions where convenient, safe, secure, attractive and sustainable entrances are required.

Core Product Systems include:

- Sliding doors
- Swing doors
- Revolving doors
- Pedestrian Security Lanes & Gates

For further information please email us at architect.esuk@faactechnologies.com

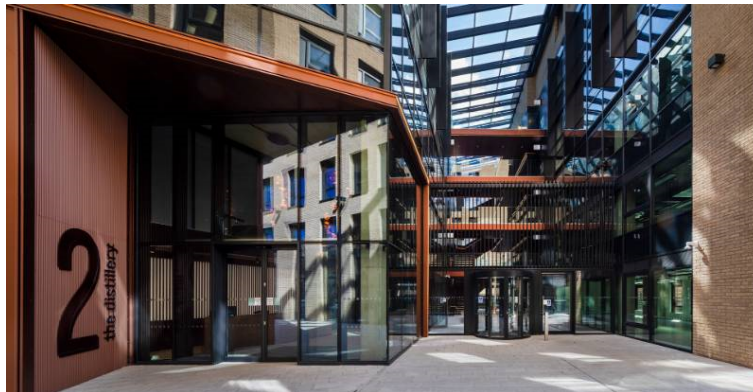

Available CPD Material (5)



ABC of automatic doors- Access & Equality, Benefits and Considerations.

This seminar offers an overview of the factors to take into account when considering automatic door openers and the associated accessories, increasing specifiers' knowledge with regard to the general benefits of automated pedestrian entrances. The CPD covers key elements of The Equalities Act 2010, EN 16005, BS 7036, BS 9999, BS 83000 and Building Regulations Part B, Part L, Part M and Part Q (PAS24). The aim is to increase awareness across the following automatic door types:

- Automatic linear and curved sliding doors and sliding door operators
- Automatic swing doors and swing door operators
- Revolving doors
- Space saving / balanced doors

By the end of the CPD you should have a greater understanding of:

- The considerations of building types, considering sustainability, functionality, and fire and safety requirements.
- Considering how the door will be used and by whom and what solutions are available to the specifier
- A greater understanding of EN standards and local building regulations
- Safety: Understanding the requirements for each type of automatic door solution
- Security: SBD guidance, PART Q, PAS 24, LPS1175 and EN 1627 regulations

Material type: Online Learning, Seminar

RIBA Core Curriculum: **Design, construction and technology**
Inclusive environments

Knowledge level: General Awareness



Multiple formats

A Good Idea All Round- Important considerations when specifying revolving doors

This CPD provides the architectural specifier with a structured approach to the correct selection and detailed specification of the most appropriate revolving door type for any given application. In order to bring the training to life, the audience are encouraged to bring a real project to the training for consideration.

- The case for revolving doors
- How to select an appropriate revolving door, looking at size, configuration, traffic patterns, building type and aesthetics
- Functional considerations, operational management, automatic versus manual operation, access control and vulnerable users
- Design details to consider, locking and security, thermal performance, and air permeability
- How to create an entrance profile and specification proposal, including hazard analysis and risk assessment.

By the end of the CPD you should have a greater understanding of:

- The considerations of building types, considering sustainability, functionality, and fire and safety requirements.
- Considering how the door will be used and by whom
- A greater understanding of EN standards and Building Regulations
- Understanding footfall and how this influences the type of revolving door being specified
- Installation and interfacing of revolving door with surrounding trades.

Material type: Literature, Seminar

RIBA Core Curriculum: **Design, construction and technology**
Inclusive environments

Knowledge level: General Awareness



Multiple formats

Specifying Revolving Doors

This CPD provides the architectural specifier with a structured approach to the correct selection and detailed specification of the most appropriate revolving door type for any given application. In order to bring the training to life, the audience are encouraged to bring a real project to the training for consideration. This seminar will help you to understand the following topics:

- The case for revolving doors
- How to select an appropriate revolving door, looking at size, configuration, traffic patterns, building type and aesthetics
- Functional considerations, operational management, automatic versus manual operation, access control and vulnerable users
- Design details to consider, locking and security, thermal performance and air permeability
- How to create an entrance profile and specification proposal, including hazard analysis and risk assessment

This CPD can be delivered to you live and remotely

Material type:

Online Learning, Seminar

RIBA Core Curriculum:

Design, construction and technology
Inclusive environments

Knowledge level:

General Awareness



Multiple formats

Automatic Doors for Pedestrians: The Benefits and Considerations

This seminar offers an overview of the factors to take into account when considering automatic doors, automatic door openers and the associated accessories, increasing specifiers' knowledge with regard to the general benefits of automated pedestrian entrances. The CPD covers key elements of EN16005, BS7036, BS9999, BS8300 and Building Regulations Part B, Part L, Part M and Part Q(PAS24). The aim is to increase awareness across the following automatic door types:

- Automatic sliding doors and sliding door operators
- Automatic swing doors and swing door operators
- Automatic revolving doors and manually operated revolving doors
- Space saving doors

This CPD can be delivered to you live and remotely.

Material type:

Online Learning, Seminar

RIBA Core Curriculum:

Design, construction and technology
Inclusive environments
Legal, regulatory and statutory compliance

Knowledge level:

General Awareness



Multiple formats

Automatic Doors for Pedestrians: Access and the Equality Act

The seminar provides an overview of factors to take into account when considering access issues of the Equality Act. It looks at how automatic doors and automatic entrances can help meet the requirements of the Act. It covers key sizes of doors, level threshold requirements and activation positioning. Also key elements of EN16005, BS7036, BS8300 and Building Regulations Part M. It covers

- Automatic sliding doors and sliding door operators
- Automatic swing doors and swing door operators
- Automatic revolving doors and manually operated revolving doors
- Space saving doors

This CPD can be delivered to you live and remotely.

Material type:	Online Learning, Seminar
RIBA Core Curriculum:	Design, construction and technology Inclusive environments Legal, regulatory and statutory compliance
Knowledge level:	General Awareness

Classifications

Subject/Product Areas (CI/SfB)

Environment

Planning, land > General

Structure

Doors: general > Access doors

Doors: general > Advisory organisations

Doors: parts, accessories > Door openers

Doors: parts, accessories > Door closers

Doors: parts, accessories > Sliding and folding door gear

Doors: industrial > Advisory organisations

Doors: industrial > Industrial doors

RIBA Core Curriculum areas

Design, construction and technology

Knowledge level: *General Awareness*

Inclusive environments

Knowledge level: *General Awareness*

Legal, regulatory and statutory compliance

Knowledge level: *General Awareness*